

**ITEM 15. MOBILE CRANES – TEMPORARY ROAD CLOSURES – EBSWORTH
STREET ZETLAND**

TRIM RECORD NO: 2017/472190

RECOMMENDATION

It is recommended that the Committee endorse the temporary road closure of Ebsworth Street, Zetland, between Bourke and Portman Streets, on Saturday 16 December and Sunday 17 December 2017, inclusive, subject to the following conditions:

- (A) The Applicant must comply with the temporary road closure conditions as mentioned in Schedule B of this Agenda.
- (B) The Applicant must comply with any other conditions imposed by City's Construction Regulation Unit.
- (C) The Applicant must provide an alternate solution for vehicular access to all properties fronting Ebsworth Street during the temporary road closure and submit to the City for review and approval at least three weeks prior to the work.
- (D) The Applicant has indicated Saturday 6 January 2018 to Sunday 7 January 2018 inclusive as alternative dates in case of inclement weather.
- (E) The Applicant must contact Redfern Police to obtain a separate police permit and to discuss deployment of user pay police for the road closure.
- (F) The Applicant is to obtain a Road Occupancy Licence from the Transport Management Centre prior to commencement of works.
- (G) The Applicant must liaise directly with Woolworths Green Square and the Strata Manager of 18 Ebsworth Street, Zetland, to discuss servicing and car park access during the temporary road closure at least 14 days prior to the work.
- (H) The Applicant must distribute notification letters to affected stakeholders at least 14 days before the temporary road closure and provide a name and telephone number of the supervisor responsible for the proposed closure in the notification letter.

VOTING MEMBERS FOR THIS ITEM

<i>Voting Members</i>	<i>Support</i>	<i>Object</i>
City of Sydney		
Roads and Maritime Services		
NSW Police – Redfern LAC		
Representative for the Member for Heffron		

DECISION

BACKGROUND

Construction Solutions NSW has applied for the temporary road closure of Ebsworth Street, Zetland, between Bourke and Portman Streets, on Saturday 16 December and Sunday 17 December 2017, inclusive.

COMMENTS

The proposed temporary road closure is required to allow a mobile crane to remove an on-site tower crane at 960 Ebsworth Street, Zetland.

The Applicant has provided a site-specific Traffic Control Plan that includes details of barricades, signs, flagmen and other traffic devices to implement the proposed road closure.

There are currently no other approved temporary road closures proposed to take place on the same day in close proximity of this closure.

The temporary road closure will not affect any other properties, as local access will be provided at all times and alternative access routes are available nearby.

A Traffic Management Plan (TMP) for the temporary road closure was approved by Roads and Maritime Services (RMS).

CONSULTATION

The Applicant will be required to notify affected stakeholders as stipulated in Schedule B.

FINANCIAL

All costs associated with the proposed closure will be borne by the Applicant.

Mobile Cranes – Temporary Road Closures – Ebsworth Street, Zetland

Claudia Calabro, Traffic Works Coordinator

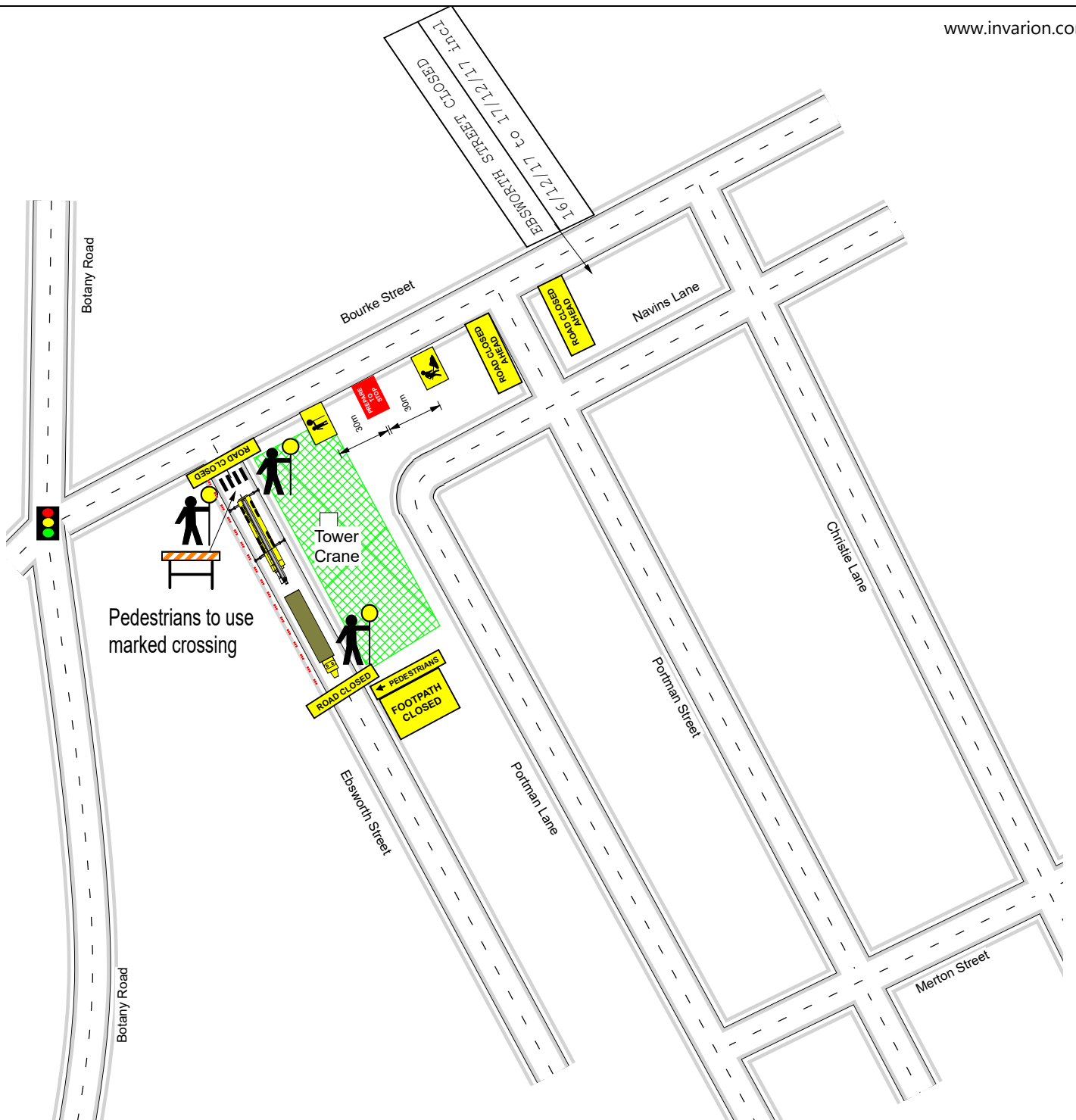

Manifest	
1 x	all terrain 4 axle
1 x	Barrier
17 x	Pedestrian Tape
1 x	semi trailer
1 x	T1-18 prepare to stop
1 x	T1-200-2* traffic controller ahead symbolic day (yellow)
1 x	T1-5-2 * workers ahead symbolic day
2 x	T2-4 road closed
2 x	T2-Q02a road closed ahead T2-Q02a
1 x	T8-2L pedestrians (L)
1 x	T8-4 T8-4
3 x	traffic controller
1 x	traffic light

Date: 12/09/2017 **Author:** Steve Spiteri **Project:** TITAN CRANES EBSWORTH STREET ZETLAND
RMS License: 2452057913 **Onsite Contact:** Sam 0400 458 717

- Comments:**
1. MOBILE CRANE SET UP ON EBSWORTH STREET
 2. Pedestrians controlled by traffic staff
 3. Vehicles to follow traffic controller directions
 4. FULL ROAD CLOSURE
 5. VMS BOARD AND LOCAL LETTER NOTIFICATIONS 7 DAYS PRIOR

This traffic plan is drawn in accordance with AS1742.3 and the RMS Traffic Control At Work Sites manual. It is to be implemented as such. This 'traffic control plan' is a guide only and can be altered and signed onsite by an accredited RMS licensed person. Approach speed as set by RMS sign posted limits. Day/Night class 1 reflective signs to be used. RMS accredited traffic controllers to be employed. All traffic controllers to wear approved hi visibility personal protective equipment.

